

PROPOSED RETAINING WALL		
FROM STATION	TO STATION	QUANTITY (LF)
25+00.00	25+52.70	51.47

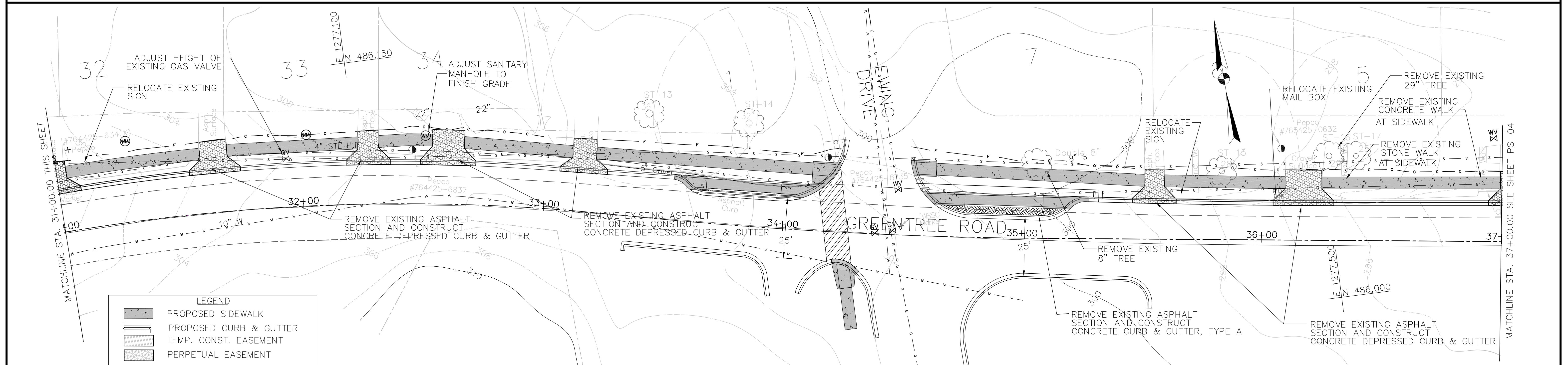

LEGEND

	PROPOSED SIDEWALK
	PROPOSED CURB & GUTTER
	TEMP. CONST. EASEMENT
	PERPETUAL EASEMENT
	PROPOSED STORM DRAIN
	PROPOSED RETAINING WALL
	PROPOSED RIGHT OF WAY
	ASPHALT OR CONCRETE SECTION TO BE REMOVED
	ASPHALT OR CONCRETE SECTION TO BE INSTALLED
	EXISTING RIGHT OF WAY
	EXISTING EDGE OF LANE
	EXISTING TREE

PS-03

MONTGOMERY COUNTY DEPARTMENT OF TRANSPORTATION GAITHERSBURG, MARYLAND		PLAN SHEET 3
RECOMMENDED FOR APPROVAL Chief, Design Section _____ Date _____ APPROVED		GREENTREE ROAD SIDEWALK CONSTRUCTION FROM MD 187 TO FERNWOOD ROAD
Chief, Division of Transportation Engineering _____ Date _____ Designed by: <u>HVN</u> Drawn by: <u>HVN</u> Checked by: <u>DMS</u>		
NOTE: NOVEMBER, 2010		Project No.: 500506 Scale: 1" = 20'-0" Sheet 7 of 35

NO.	REVISION	DATE	BY